

Reference: R 1001A

Designation: swivel fitting, countersunk head – insulated glass unit.



Typical applications:

Mounting		Alternate product
Vertical facade	Yes	R1003A
Roof/canopy	Possible	
Guard rail	No	
*Blind access	No	
Sloped glazing	Yes	

*Installation from the outside (no access to the structure).

Patent No: 9806556

Dimensions:

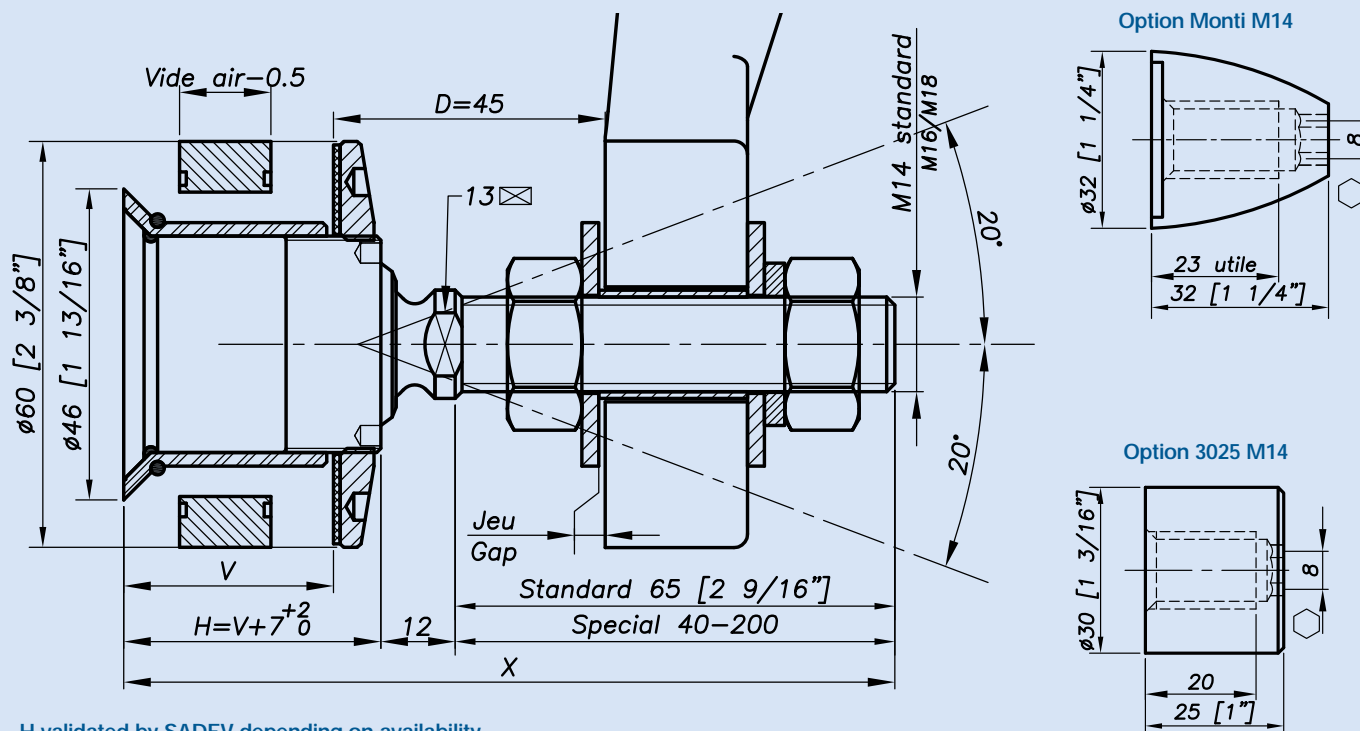

H validated by SADEV depending on availability.

Glass drilling:

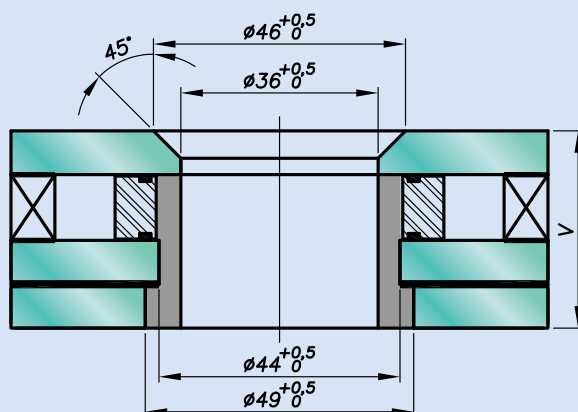

It is important to provide the following information with each request: the glass composition (ex.: 10 mm monolithic, 8.8.4 laminated, 8.8.2-12-10 insulating) / the length and diameter of the threaded axle if not standard dimensions (M14, 65 mm) / the reference of the spider to be used as support, or the thickness of an existing support for the delivery of the spacer.

Reference: R 1001A

Mechanical performances:

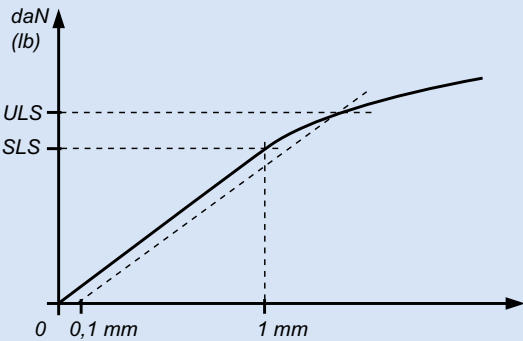

	Bending capacity			Pull out capacity
	D	SLS*	ULS*	ULS*
M14	45 mm	344 daN (773 lb)	577 daN (1297 lb)	2000 daN (4496 lb)
	60 mm	153 daN (344 lb)	364 daN (818 lb)	
M16	45 mm	504 daN (1133 lb)	827 daN (1859 lb)	2000 daN (4496 lb)
	60 mm	253 daN (569 lb)	525 daN (1180 lb)	

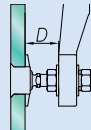

*SLS – Serviceability Limit State: load at 1 mm deformation.
 *ULS – Ultimate Limit State: load at the elastic limit (Rp0.1).
 Values are given without factor of safety.
 Tests available online: www.sadev.com

Components:

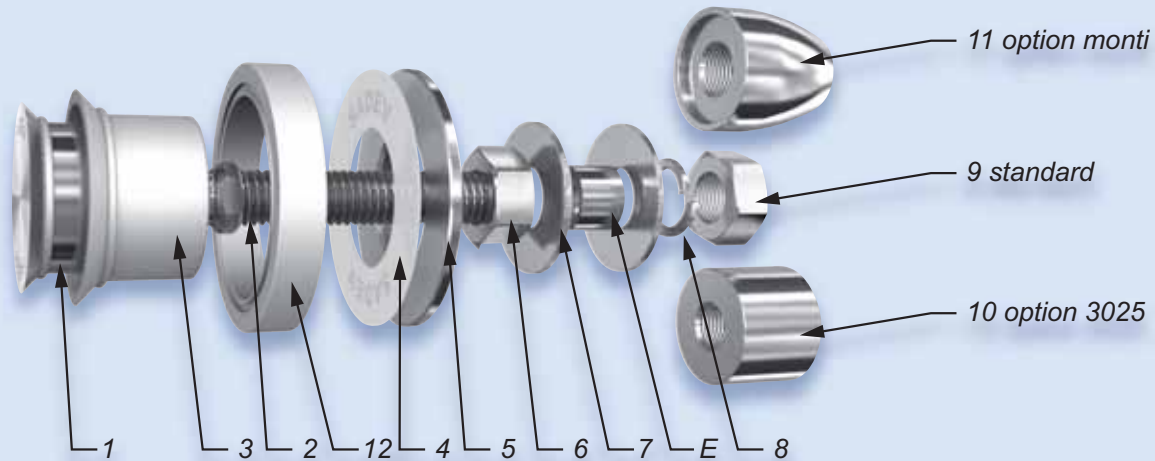

Rep	Qty	Designation	Material
1	1	Swivel Body	X2 Cr Ni Mo 17.12.2 per EN 10088-3
2	1	Threaded Axle	X4 Cr Ni Mo 16.5.1 per EN 10088-3
3	1	Glass Hole Grommet	AW-1050A per EN 573-3 / Al 99.5%
4	1	Contact Washer	White polyacetal / white polyethylene
5	1	Glass Nut Ø 60	X2 Cr Ni Mo 17.12.2 per EN 10088-3
6	1	Nut DIN 934	A4
7	2	Washer	A4
8	1	Lock Washer DIN127	A4
9	1	Nut DIN 934	A4
10	1	3025 Cap Nut - Option	X2 Cr Ni Mo 17.12.2 per EN 10088-3
11	1	Monti Cap Nut - Option	X2 Cr Ni Mo 17.12.2 per EN 10088-3
12	1	Spacing Ring	AlCu4PbMg/2030/AW-2030 per EN 573-3

Suggested mounting instruction:

1 – In factory: assembly of glass

Suggested method only, not considered to replace the recommendations of the glass manufacturer.

Mount spacing ring No. 12 between the two pieces of glass using 3 mm butyl cord applied into the grooves. Assemble the IG unit. Insert glass hole grommet No. 3 and secure using a neutral cure silicone.

2 – On site

Insert parts No. 1/2 into the glass hole. Place the contact washer No. 4 over assembly No. 1/2 and thread on the glass nut No. 5. Tighten to 10 Nm (7.5 ft-lb) for tempered glass using SADEV catalog ref. 097581160 and ref. CLE-DYN-072031. Thread on nut No. 6 and apply washer No. 7. Insert the threaded axle into the support with spacer E (available on request), see technical page. Adjust the depth. Mount the second washer No. 7, lock washer No. 8, and nut No. 9. Tighten to 60 Nm (45 ft-lb) using a 22 mm wrench.

SADEV recommends using thread locking compound whenever possible.

